

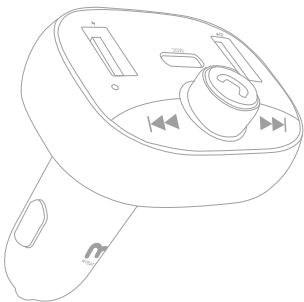

## FM Transmitter + Car Charger User Manual



Bluetooth Name : MP S-15

In order to correctly use this product, please read this user manual before use and store it in a safe place.

### Features:

This product is a multi-functional Bluetooth connector & charger. It uses 2.4G wireless transmission and FM transmitter technology. It can be used for hands-free calling and streaming music once connected with your device via bluetooth. In addition, it can charge up to 2 devices simultaneously through the dual USB ports and a USB-C port. One USB port includes 5V/2.1A charging port, while the other port is a standard 5V/1A port, the USB-C port provides PD30W power supply. The charging circuit design includes over current, over voltage, short circuit and other protective measures for your safety. The FM transmitter can be connected with two devices for hands-free calling and phone functions. It also supports USB disk and TF card to play music. Unit can detect if the car's battery voltage is within normal range and alert you if it is too low, to prevent failure of starting the vehicle. The product is designed to be modern and sleek with a low profile. The LED display can display the FM channel, song and battery voltage. Easy to use and essential for every driver!

### Notice:

- Keep away from children. Do not allow children to plug this product into the cigarette lighter socket, control any functions or charge devices.
- The input voltage of this product is DC12 - 24V. Any use of this product beyond the specified voltage range is not recommended and can lead to damages.
- We recommend unplugging the product from the socket if not in use.
- Please avoid local FM channels with a strong radio signal as it will affect the quality of your streaming and hands-free experience.
- Do not disassemble the product.

### Buttons and interface:

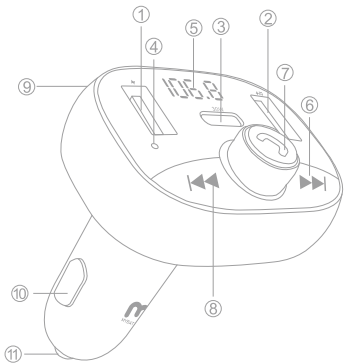

- 1 USB Charging Port 1: 5V/2.1A
- 2 USB Charging Port 2: 5V/1A & USB playback
- 3 USB-C: (PD 30W) 5V/3A, 9V/3A, 12V/2.5A
- 4 Mic
- 5 LED Display Screen
- 6 Next Track
- 7 Multi-Function Button (Play/Pause/Answer/End/Volume+/Volume- etc.)
- 8 Previous Track
- 9 TF Card Port
- 10 Negative
- 11 Positive

### Main function:

01. Stream Music
02. Hands-Free Calling
03. Dual USB Port Charging
04. FM Transmitter
05. Battery Voltage Detection

06. USB Disc / TF Card
07. Connect two devices simultaneously
08. LED display screen
09. Support no damage to play music
10. System voice broadcast

### Instructions:

- Insert the FM Transmitter into the cigarettes lighter socket of the car. The LED Display screen will light up, the LED display will light up and display the vehicle voltage, BT and FM frequency alternately.

- Adjust the FM frequency: Turn on the car radio and select an empty channel frequency from your car's radio settings. An empty channel will have static or white noise sounds. Then, press and hold [ ] for 2 seconds on the FM Transmitter. Once the LED Display is flashing, select the same FM channel on the car radio for MP S-15. When both channels are synced, make sure your device is connected via bluetooth to MP S-15 (see Bluetooth Setup) to stream music and use hands-free functions. (Note: For the best quality sound, select an FM channel frequency that has no interruptions from another channel or local radio station.)

- Switch Modes: Double click the [ ] button to switch between functions such as USB Disc or TF card.

### Bluetooth Setup:

- Connect your device with the FM Transmitter. Turn on the Bluetooth settings on your device and search for the FM Transmitter (MP S-15). Select MP S-15 to wirelessly pair with the FM

Transmitter. Once it has successfully paired, the system's voice will say "Connected". It will automatically pair with this same device in the future if there are no changes to the bluetooth settings.

### Hands-Free Calling:

- Answer Call: Quickly press the hands-free button [ ] once
- End Call: During the call, quickly press the hands-free button [ ] once.
- Reject Incoming Call: Press and hold the hands-free button [ ] for 2 seconds.

### Play Music:

- The default method for playing music is the wireless U disc or TF card.
- Once the bluetooth is successfully connected, press [ ] to change the player to stream music from the phone.
- Press [ ] to select the previous song; Press [ ] to select next song.
- Turn the knob counterclockwise to turn down the volume; Turn the knob clockwise to increase the volume.
- While music is playing, quickly press [ ] to play / pause.

### Key Functions:

Answer Call	Quickly press the hands-free button [ ] once
-------------	--

End Call	During the call, quickly press the hands-free button [ ] once.
Reject Incoming Call	Press and hold the hands-free button [ ] for 2 seconds.
Play Music	Once the bluetooth is successfully connected, quickly press [ ] to change the default player to stream music from the phone.
Previous Track / Next Track	Quickly press [ ] to select the previous song; Quickly press [ ] to select next song.
Volume	Turn the knob counterclock wise to turn down the volume; Turn the knob clockwise to increase the volume.
Play / Pause	While music is playing, quickly press [ ] to play / pause.
Change FM Frequency Channel	Press & Hold [ ] for 2 seconds. Once the display flashes, Rotary knob to select the channel frequency.
Switch Modes	Press and hold [ ] for 5 seconds to switch between functions such as USB Disc or TF card.

### Car Charger:

- 1.USB Charging Port 1: 5V/2.1A
- 2.USB Charging Port 2: 5V/1A
- 3.USB-C: (PD 30W) 5V/3A, 9V/3A, 12V/2.5A

### Parameters:

Name	Car wireless MP3 player
Model	MP S-15
Input voltage	DC12-24V
USB1 Output	5V/2.1A
USB2 Output	5V/1A
USB-C Output	5V/3A, 9V/3A, 12V/2.5A
FM frequency	87.5-108.0MHz
FM emission distance	<5 m
Wireless version	V 5.0
Effective distance	About 10 meters
Support USB disk	≤ 32G
Audio format	Mp3 / WAV / FLAC / APE / WMA
Applicable models	General (12V / 24V)
For mobile phones	iOS / Android

### FAQs:

Q: Can I change the FM frequency channel?  
A: Yes, press & hold the hands-free button for 2 seconds, then select a new channel from the Transmitter. It must be on the same channel as the car's radio in order to sync.

Q: My device can locate MP S-15 in the bluetooth settings, but it cannot connect. How can I connect my phone to the FM Transmitter?  
A: Confirm there are no other devices currently connected with the FM Transmitter. Disconnect all devices from MP S-15 and try again.

Q: Is it safe to charge a device using the port?  
A: Yes, it is safe and protected with standard circuits.

Q: Does it support GPS Navigation?  
A: Yes, it can stream the audio navigation directions through your device's GPS if connected to the bluetooth.

Q: Why can't my device locate MP S-15 for setup?  
A: Ensure the car is turned on, and the FM Transmitter is connected to the power source. If everything is turned on, ensure the bluetooth settings on your device is on too.

Q: Why is there no sound playing from the car?  
A: Check to make sure the FM frequency channel is not being interrupted by a local radio station.

### FCC STATEMENT:

This equipment has been tested and found to comply with the limits for a Class B digital device, pursuant to Part 15 of the FCC Rules. These limits are designed to provide reasonable protection against harmful interference in a residential installation. This equipment generates uses and can radiate radio frequency energy and, if not installed and used in accordance with the instructions, may cause harmful interference to radio communications. However, there is no guarantee that interference will not occur in a particular installation. If this equipment does cause harmful interference to radio or television reception, which can be determined by turning the equipment off and on, the user is encouraged to try to correct the interference by one or more of the following measures:

- Reorient or relocate the receiving antenna.
  - Increase the separation between the equipment and receiver.
  - Connect the equipment into an outlet on a circuit different from that to which the receiver is connected.
  - Consult the dealer or an experienced radio/TV technician for help.
- This device complies with part 15 of the FCC Rules. Operation is subject to the following two conditions:
- (1) This device may not cause harmful interference, and
  - (2) this device must accept any interference received, including interference that may cause undesired operation.Changes or modifications not expressly approved by the party responsible for compliance could void the user's authority to operate the equipment.

**WARNING:** Cancer and Reproductive Harm  
[www.P65Warnings.ca.gov](http://www.P65Warnings.ca.gov)  
Made in China

[www.mybatpro.com](http://www.mybatpro.com)

SCAN QR CODE TO ACCESS LIFETIME WARRANTY

MADE IN CALIFORNIA