

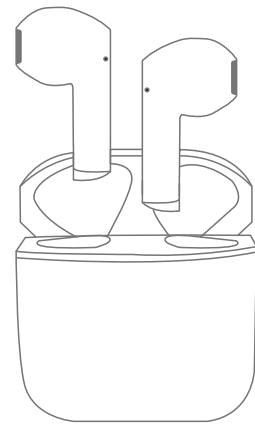

# METTLE TRUE WIRELESS EARBUDS



User Manual  
Model: MyBat Pro Mettle

## WELCOME

Thank you for using the MyBat Pro Mettle True Wireless Earbuds. Using the purest wireless sound, you can enjoy a high-definition audio experience that is clear, natural, and unrivaled.

Please read this user manual carefully and keep it for future reference.

## PACKAGE CONTENTS

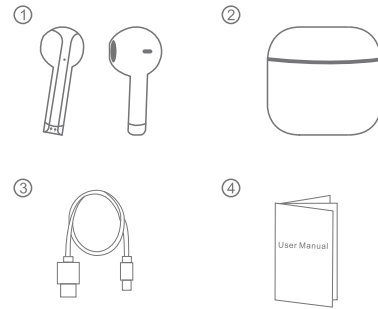

1. Mettle True Wireless Earbuds
2. Charging Case
3. USB-C Charging Cable
4. User Manual

## PRODUCT OVERVIEW

### Earbuds

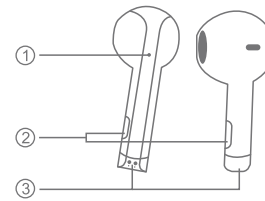

1. LED Indicator
2. Smart Touch Controls
3. Charging Contact

### Charging Case

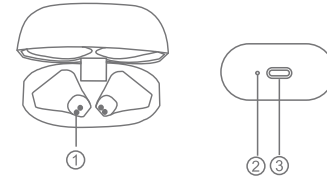

1. Charging Pins
2. LED Charging Indicator
3. USB-C Charging Port

## HOW TO CHARGE

Fully charge your earbuds and case before first use. A full charge of the earbuds takes 1 hour, while a full charge of the charging case takes 2 hours.

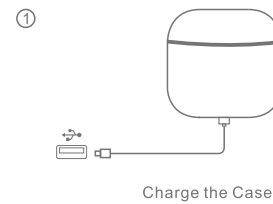

Charge the Case

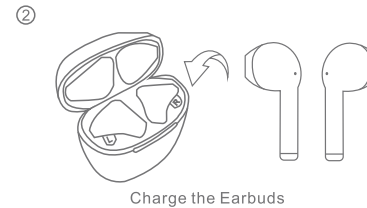

Charge the Earbuds

### Charging Case

1. Connect the included USB-C charging cable to a power supply and plug it in to charge the case.

### Earbuds

2. The earbuds will charge when placed inside the case.

**NOTE:** Opening or closing the charging case activates the LED indicator. Before charging, make sure the earbuds and USB-C port are dry, as this may cause delays or failures.

## CHARGING CASE INDICATOR STATUS



Charging (White Light Always On)

○ Fully Charged (No Light)

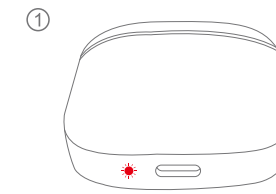

Charging  
(White Light Always On)

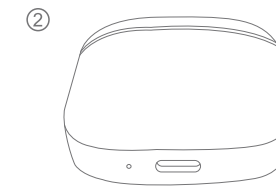

Fully Charged  
(No Light)

## POWER ON/OFF

### Power On:

Open the charging case and remove the earbuds.

### Power Off:

When placed in the charging case with the lid closed, the earbuds will automatically power off.

**NOTE:** After 3 minutes without a Bluetooth connection, the earbuds will automatically shut off.

ON

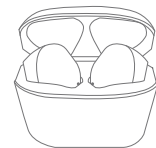

OFF

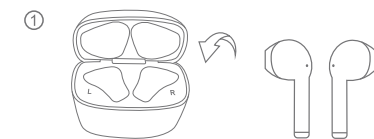

2

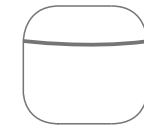

## HOW TO PAIR

### True Wireless Stereo Connectivity

The right earbud will automatically connect with the left earbud once the charging case is opened.

### Pairing To Your Devices

1. Upon opening the charging case, the earbuds will automatically turn on and enter pairing mode.
2. Ensure your device's Bluetooth settings are turned on.
3. Select "MyBat Pro Mettle" from the list of found devices and pair.

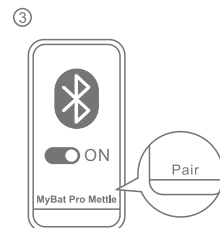
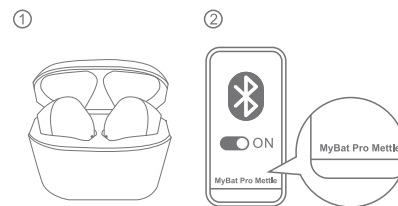

## AUDIO CONTROLS

Play / Pause	Tap 1x (L/R)
Previous Track	Tap 2x (L)
Next Track	Tap 2x (R)
Volume-	Tap & Hold (L)
Volume+	Tap & Hold (R)

## CALL CONTROLS

Answer / End Call	Tap 1x (L/R)
Reject Call	Tap & Hold (L/R)(2 Secs)

## VOICE CONTROLS

Activate Siri & Other Assistants	Tap 3x (L/R)
----------------------------------	--------------

## SPECIFICATIONS

**Model:** MyBat Pro Mettle  
**Input:** DC 5V/500mA  
**Rated Output Power:** 5mW  
**Battery Capacity:** 30mAh x 2 (Earbuds), 300mAh (Charging Case)  
**Charging Time:** 1 Hour (Earbuds), 2 Hours (Charging Case)  
**Playtime:** 4 Hours  
**Bluetooth Version:** 5.1  
**Bluetooth Range:** 10m/33ft  
**Frequency Response:** 20Hz ~ 20kHz  
**Impedance:** 32Ω  
**Bluetooth Frequency:** 2402mHz - 2480MHz  
**Bluetooth Profile:** AVRCP, A2DP, HFP, HSP  
**Audio Codec Format:** SBC, AAC, aptX

## IMPORTANT SAFETY INSTRUCTIONS

To avoid hearing damage, limit the time you use headphones at high volume and set the volume to a safe level. The louder the volume, the shorter the safe listening time is.

Be sure to observe the following guidelines when using your earpieces.

- Listen at reasonable volumes for reasonable periods of time.
- Be careful not to adjust the volume continuously upwards as your hearing adapts.
- Do not turn up the volume so high that you can't hear what's around you.
- You should use caution or temporarily discontinue use in potentially hazardous situations.
- Excessive sound pressure from earphones and headphones can cause hearing loss.
- Using headphones with both ears covered while driving is not recommended and may be illegal in some areas while driving.
- For your safety, avoid distractions from music or phone calls while in traffic or other potentially dangerous environments.

## FCC STATEMENT

This equipment has been tested and found to comply with the limits for a Class B digital device, pursuant to Part 15 of the FCC Rules. These limits are designed to provide reasonable protection against harmful interference in a residential installation. This equipment generates and can radiate radio frequency energy and, if not installed and used in accordance with these instructions, may cause harmful interference to radio communications. However, there is no guarantee that interference will not occur in a particular installation. If this equipment does cause harmful interference to radio or television reception, which can be determined by turning the equipment off and on, the user is encouraged to try to correct the interference by one or more of the following measures:

- Reorient or relocate the receiving antenna.
- Increase the separation between the equipment and receiver.
- Connect the equipment into an outlet on a circuit different from that to which the receiver is connected.
- Consult the dealer or experienced radio/TV technician for help.

This device complies with Part 15 of the FCC Rules. Operation is subject to the following two conditions:

- (1) This device may not cause harmful interference and
- (2) this device must not accept any interference received, including interference that may cause undesired operation.

Changes or modifications not expressly approved by the party responsible for compliance could void the user's authority to operate the equipment.

**WARNING:** Cancer and Reproductive Harm  
[www.P65Warnings.ca.gov](http://www.P65Warnings.ca.gov)  
Made in China



SCAN QR CODE TO ACCESS LIFETIME WARRANTY

