



OASIS

WATERPROOF BLUETOOTH SPEAKER



User Manual

Model: MyBat Pro Oasis

Safety Measures

To ensure proper use of this product, please take the time to read this instruction manual carefully before use. Please observe all the instructions about safe operation and please keep this instruction manual in a safe place for future reference.

1. Protection of power supply wire: Do not place the cable in the path of foot traffic. Do not place heavy furniture on the cable. Never pull the cable to unplug the unit from the socket, always disconnect the unit from the main power supply by pulling the plug out of the socket.
2. Ventilation: In order to prevent this unit from overheating, place it in a well-ventilated area on a stable surface. Never place it on a bed, sofa or carpet where the ventilation will be restricted.
3. Dismantling: In order to avoid the risk of electric shock, do not dismantle the unit. Should your unit be faulty or broken please refer servicing to an authorized service center.
4. Strange Odor: Should the speaker emit any strange odor, immediately unplug it from the wall socket. Do not use the unit again until you have had it repaired or contacted the manufacturer.
5. Do not expose this unit to liquid of any kind.

What's in The Box

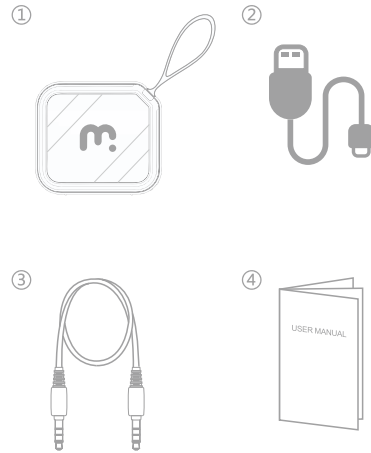

1. MyBat Pro Oasis Bluetooth Speaker x 1
2. Micro USB Charging Cable x 1
3. 3.5mm Audio Cable x 1
4. User Manual x 1

Product Overview

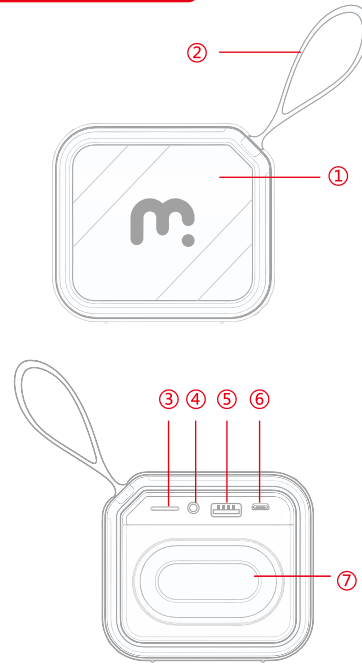

1. Speakers
2. Silicone Hand Strap
3. TF Card Slot
4. Aux Input Port
5. U Disk Slot / Power Bank Output Port
6. Charging Port
7. Composite Bass Diaphragm

Control Panel

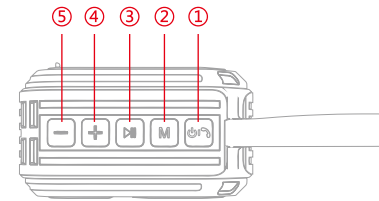

1. [Power] Press and hold to turn power on/off; Doubleclick to turn on LED Lights; For calls, click to answer or end.
2. [M] Mode: press to switch setting for Bluetooth /MP3 / FM.
3. [Play/Pause] Play / Pause; In FM mode , long press to scan FM channels (an auxiliary antenna can be plugged into the charging port).

Specifications

Model	MyBat Pro Oasis
Loudspeaker Output	8W
Horn Size	57mm
Bluetooth Version	5.0
Bluetooth Range	10m / 33ft
Frequency Response Range	90Hz – 20KHz
Signal Noise Rate	≥80DB
Battery Capacity/Voltage	2200mAh / 3.7V
Battery Charge Time	2H
Working Time	5H
USB Power Input	5V / 1A
Product Size	103 x 93 x 57mm
Product Weight	350g

Charge the Speaker

Please charge the speaker for at least 3 hours before using it for the first time. Insert the charging cable into the Micro USB charging port, connect the USB plug into a power adapter .

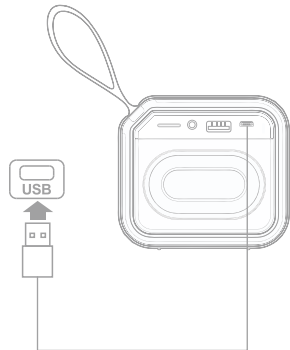

Power On / Power Off

1. Power on: Press and hold [Power] button for 3 seconds, the speaker will be turned on, and a voice prompt of "Power on" will be issued.

2. Power off: Press and hold [Power] button for 2 seconds, the speaker will be turned off, and a voice prompt of "Power off" will be issued.

Bluetooth Mode

1. Turn on the speaker, the speaker will have a voice prompt "Ready to Pair".
2. Turn on your device and activate the Bluetooth function.
3. Search for Bluetooth pairing name "MyBat Pro Oasis" and click to pair, the speaker will pair automatically and the speaker will have a voice prompt "Paired Successfully".
4. Press [Play/Pause] button to play music or control the music settings on your phone.
5. Hands-free: Press the [Power] button to answer the call; During a call, press the [Power] button to hang up the call.

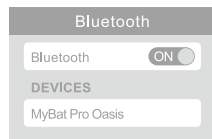
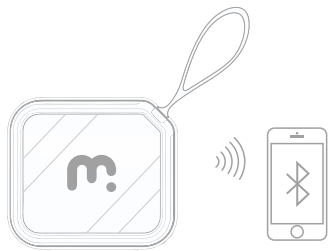

Other Connections

1. TF Card: Insert the TF card, the speaker will have a voice prompt "TF Card" and automatically play the music on the TF card.
2. U disk: Insert the U disk, the speaker will have a voice prompt "U disk" and automatically play the music on the U Disk.
3. Aux in: Use 3.5mm audio cable to connect your device to the spe the included 3.5mm AUX cable to connect "Line in".
4. FM mode: Press [M] button, to switch to the FM mode. Voice prompt will say " FM Tuner ". Long press [M] button to scan FM channels (auxiliary antenna can be plugged into the charging port).

Power Bank Function

Connect your device to a compatible charging cable and insert the USB-A end to the output port on the speaker. The speaker can charge your device simultaneously while playing music. *Charging cable is sold separately.

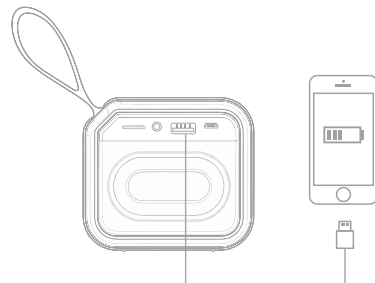

FCC Statement

This equipment has been tested and found to comply with the limits for a Class B digital device, pursuant to Part 15 of the FCC Rules. These limits are designed to provide reasonable protection against harmful interference in a residential installation. This equipment generates uses and can radiate radiofrequency energy and, if not installed and used in accordance with the instructions, may cause harmful interference to radio communications. However, there is no guarantee that interference will not occur in a particular installation. If this

equipment does cause harmful interference to radio or television reception, which can be determined by turning the equipment off and on, the user is encouraged to try to correct the interference by one or more of the following measures:

- Reorient or relocate the receiving antenna.
- Increase the separation between the equipment and receiver.
- Connect the equipment into an outlet on a circuit different from that to which the receiver is connected.
- Consult the dealer or an experienced radio/TV technician for help.

This device complies with part 15 of the FCC Rules. Operation is subject to the following two conditions:

- (1) This device may not cause harmful interference, and
 - (2) this device must accept any interference received, including interference that may cause undesired operation.
- Changes or modifications not expressly approved by the party responsible for compliance could void the user's authority to operate the equipment.

WARNING: Cancer and Reproductive Harm
www.P65Warnings.ca.gov
Made in China

CE RoHS FCC ENEC

www.mybatpro.com

